

■ Description

Due to the package design, the 67-21 series has wide viewing Angle, low power consumption and high luminous intensity, This feature makes it ideal for light pipe or lighting application. and the package quantity 2000pcs/reel.

■ Features

- White package.
- Optical indicator.
- Colorless clear window.
- Computable with automatic placement equipment.
- The product itself will remain within RoHS Compliant version.

■ Applications

- Indicator.
- Information boards.
- Lighting for small size device.

■ Absolute Maximum Ratings (at Ta=25°C)

Parameter	Symbol	Maximum Rating	Unit
Power Dissipation	P _D	60	mW
Forward Current	I _F	25	mA
Peak Forward Current (Pulse width ≤ 100 μS duty ≤ 1/10)	I _{FP}	60	mA
Reverse Voltage	V _R	5	V
Operation Temperature	Topr	-40 ~ +85	°C
Storage Temperature	Tstg	-40 ~ +90	°C
Electrostatic Discharge	ESD	2000	V
Soldering Temperature	Tsol	Reflow Soldering: 230°C for 10s Hand Soldering: 300°C for 3s	°C

TOP View Led

LK67-21AURC/TR8

Basic Characteristics

 $T_a=25^{\circ}\text{C}$

Parameter	Symbol	Condition	Min.	Typ.	Max.	Unit
Forward Voltage	V_F	$I_F=20\text{mA}$	--	2.0	2.4	V
Reverse Current	I_R	$V_R=5\text{V}$	--	--	10	μA
Dominant Wavelength	λ_D	$I_F=20\text{mA}$	--	624	--	nm
Peak Wavelength	λ_P	$I_F=20\text{mA}$	--	632	--	nm
Spectral Bandwidth	$\Delta\lambda$	$I_F=20\text{mA}$	--	20	--	nm
Luminous Intensity	I_V	$I_F=20\text{mA}$	80	150	--	mcd
50% View Angle	$2\theta_{1/2}$	$I_F=20\text{mA}$	---	120	--	deg

Package Dimensions

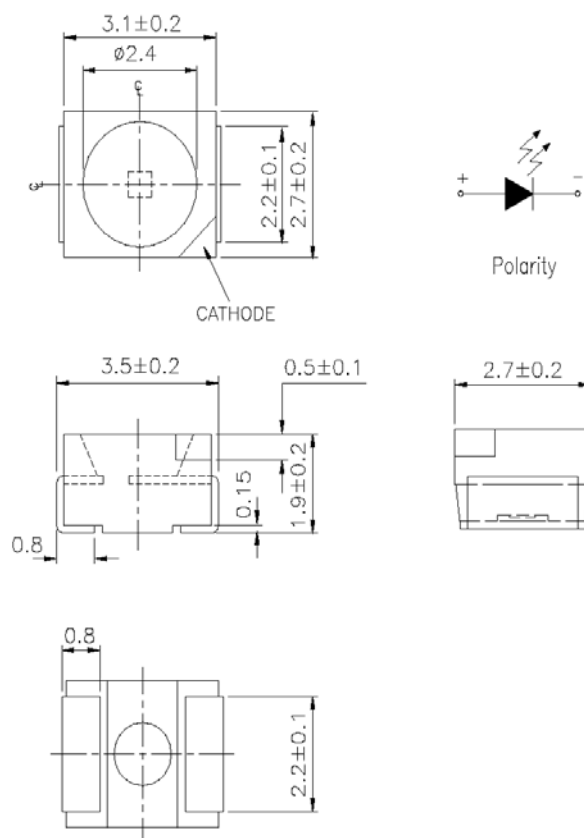

Notes: without special declared, the tolerance is +/-0.25mm

■ Typical Electrical / Optical / Characteristics Curves

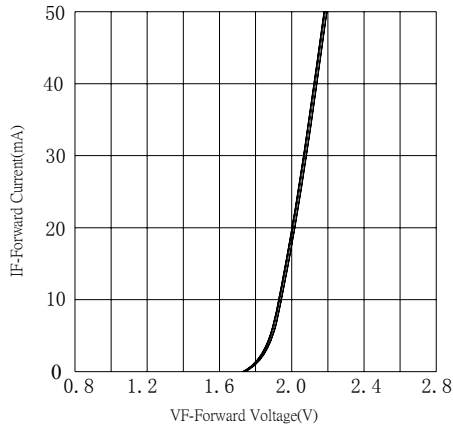

Fig.1 Forward Current vs.Forward Voltage

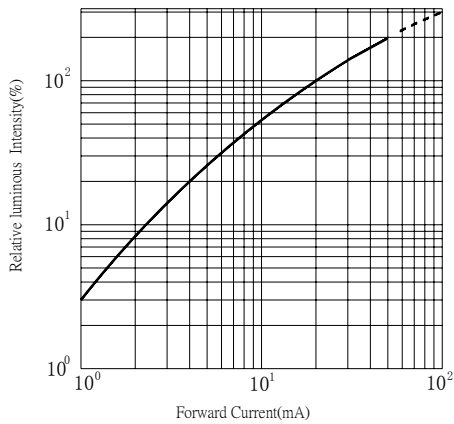
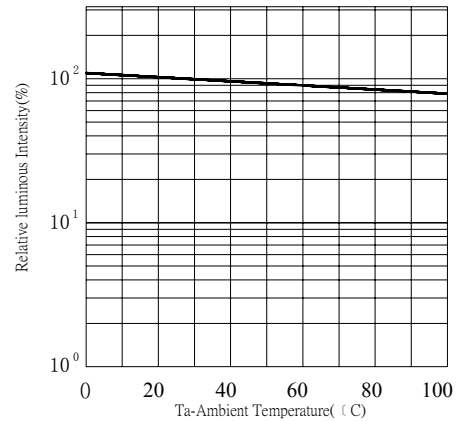

Fig.3 Relative luminous Intensity vs.Forward Current

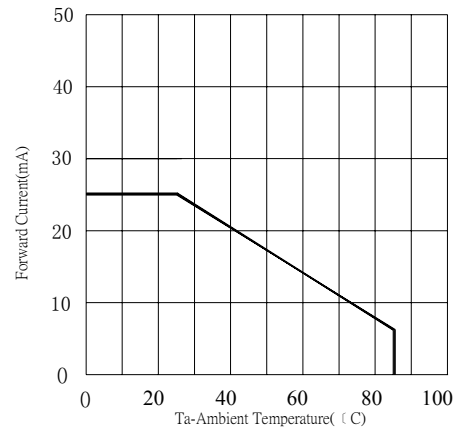

Fig.4 Forward Current vs.Ambient Temperature

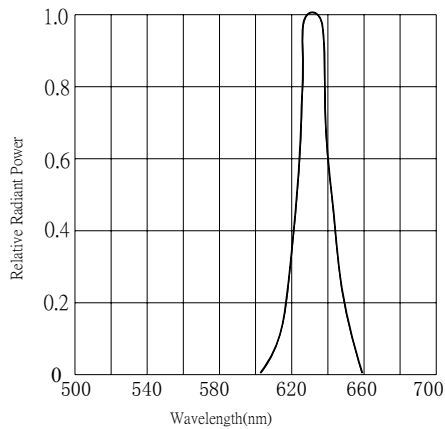

Fig.5 Relative Radiant Power vs.Wavelength

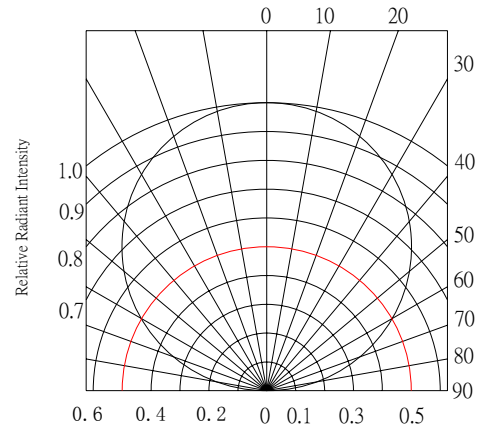

Fig.6 Relative Radiant Intensity vs.Angular Displacement

- Reflow Soldering Curves

